

Product Description

3form Ditto is a unique system that utilizes heatformed pieces of Varia Ecoresin®. Due to the modularity of Ditto, many different installations and applications are possible by combining Ditto hardware with different components of various 3form Hardware systems. This document will outline a few different possibilities to provide combination and configuration suggestions for a variety of striking applications; partitions, wall features, wall to ceiling features, ceiling features and more.

FEATURES AND BENEFITS

- Extremely easy to assemble and disassemble
- Very tough, allowing for easy fabrication and maximum durability
- Low impact 40% pre-consumer recycled content.
- Economically shipped in one box, the system is assembled onsite.

AVAILABLE COLORS

Ditto is available in a variety of standard C3 Varia Ecoresin colors. Visit www.3-form.com/materials-varia.com for all available options.

AVAILABLE FINISH

3form Ditto comes standard with both a front and back Sandstone finish. The Sandstone finish has a grainy texture with a slightly frosted look.

FLAMMABILITY & SMOKE TEST RESULTS

Ditto panels have been independently tested and meet the criteria for approved interior finishes and light transmitting resin materials as described in the 2009 International Building Code®.

TEST	3FORM DITTO	RESULT
ASTM D 2843 Smoke Density	71.6%	PASS Less than 75
ASTM D 635 Flame Spread	Self extinguishing	PASS CC1
ASTM D 1929 Self-ignition Temperature	716°F	PASS Greater than 650°F
ASTM E84-03 Flame Spread, 1/4" thickness Smoke generated	65 250	Class B: 26-75 <450

DIMENSIONS

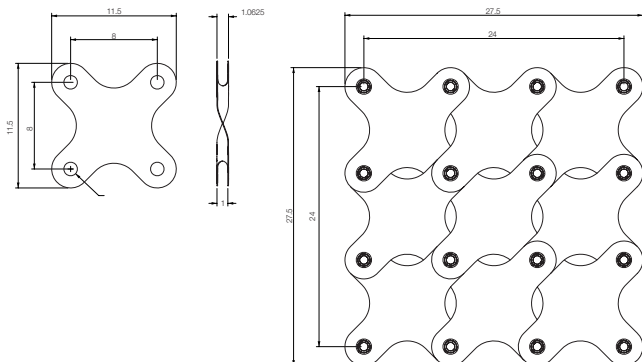

Technical Information

MATERIAL: VARIA ECORESIN 1/16" GAUGE

4'x8' panel yield = 36 tiles

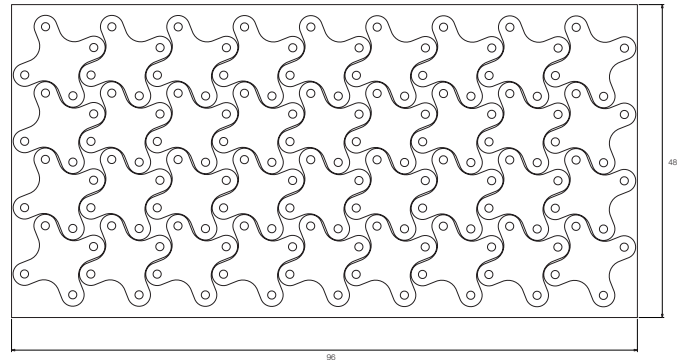

Snap In System

Ditto™ uses a snap-together system for easy installation. Ditto tiles work together in two unique configurations. Flush connection creates a smooth line with little space between tiles. 3D connection creates a more dimensional application with significant space between tiles. For the following configurations, install as directed:

The Ditto system is easy to assemble and disassemble, which allows the design to be changed easily. Once the panels are centered onto the base of the connector, simply push the cover piece straight onto the base until all three hooks are snapped into place. To remove the cover, insert a small flat head screwdriver into the three small slots to pry the hooks out of the groove as shown in the illustrations.

REMOVAL AND INSTALLATION

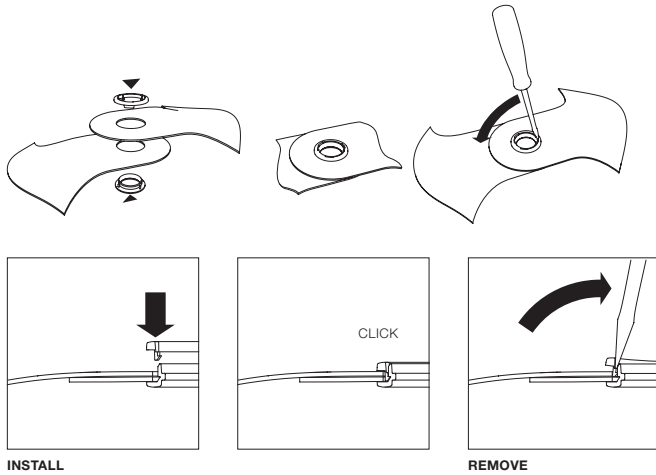

Connections

The Ditto system has three different types of panel connections. By using different combinations of connections as well as different mounting methods, you have endless design possibilities. The three connection types are illustrated below.

DOUBLE FLUSH CONNECTION

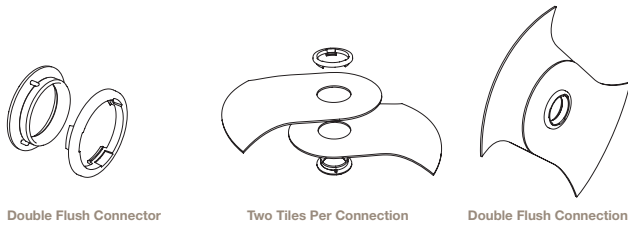

3D CONNECTION

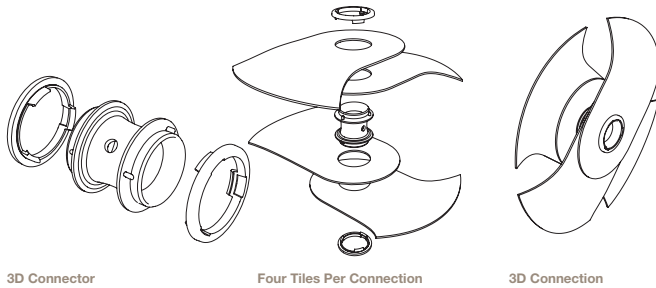

QUAD FLUSH CONNECTION

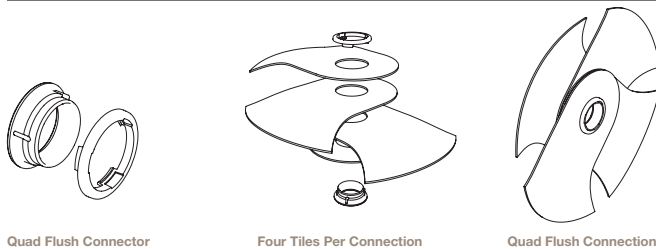

Parts Overview

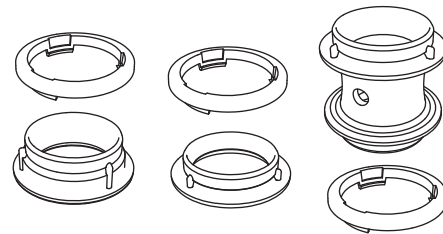
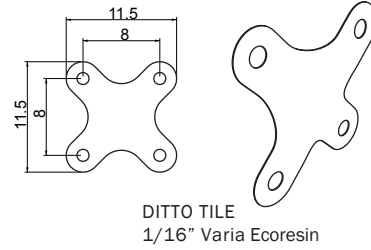

QUAD FLUSH CONNECTOR
3-85-0003

DOUBLE FLUSH CONNECTOR
3-85-0002

3D CONNECTOR
3-85-0001



WASHER
3-85-0004



REFER TO DITTO SOLUTIONS DOCUMENT FOR FASTENER TYPE PER APPLICATION

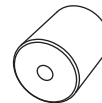

SEE POINT SUPPORT PRODUCT LINE

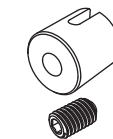
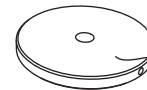

CABLE CONNECTOR
3-15-3052-K
SEE SUSPEND CABLE AND HARDWARE

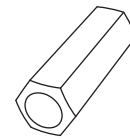

COUPLING NUT
3-15-0743

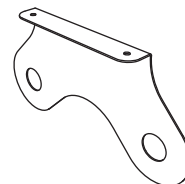

DITTO CEILING TILE
1/16" Varia Ecoresin

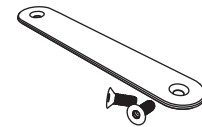

CEILING CONNECTOR FOR DITTO CEILING TILE
3-85-0005-K

TILES ASSEMBLY

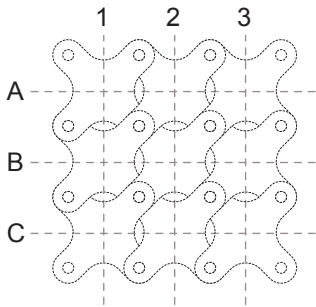

- 1- Define your layout
- 2- Use one connection type or a combination of connections

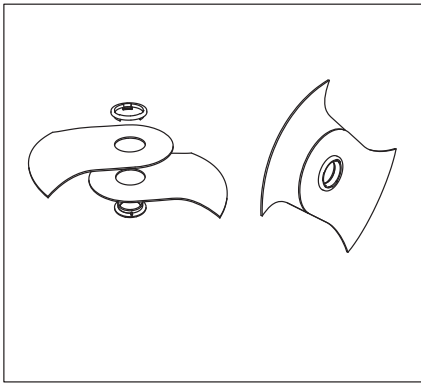

double flush connection

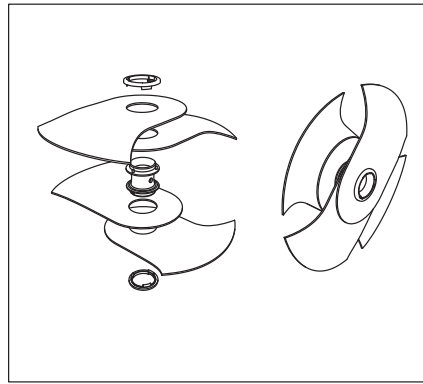

3D connection

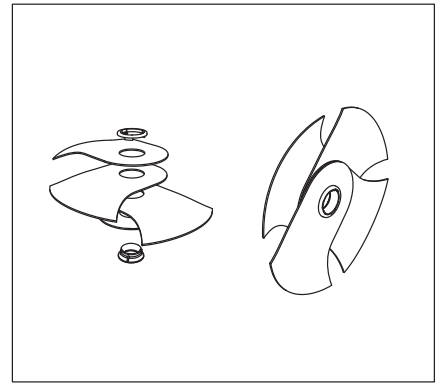

Quad Flush Connection

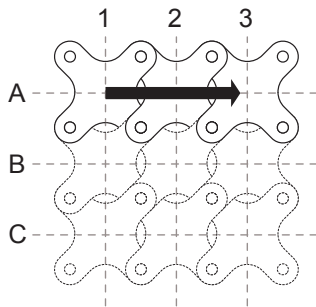

- 3- Start the tile assembly from top left.
- 4- Assemble the top row with the correct connections, making sure tiles are all in the same orientation as shown.

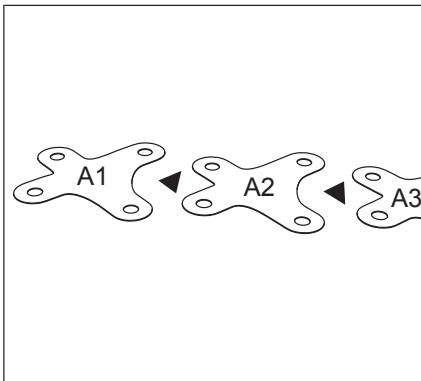

EXPLODED VIEW

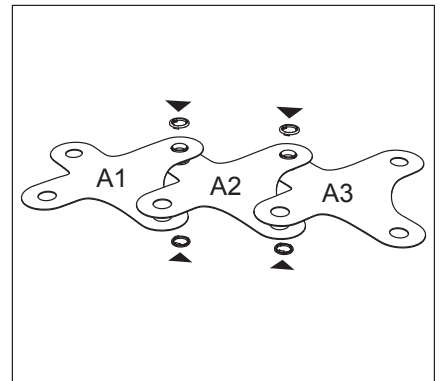
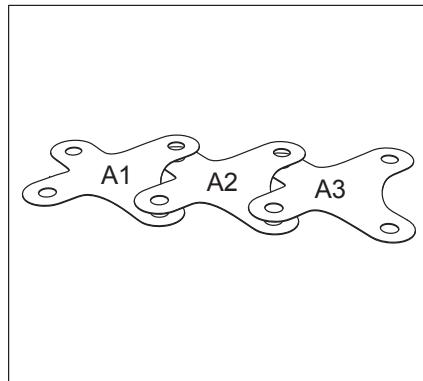

TILES ASSEMBLY

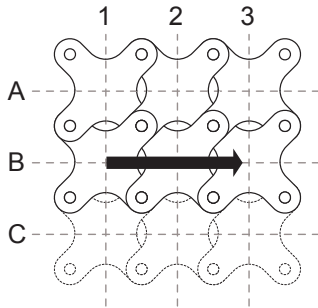

5- Continue with the second row from the left

6- Stack the upper right corner of the tile on top of the top row to get a consistent look.

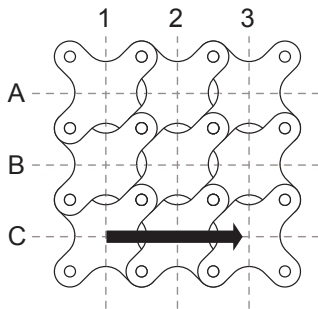
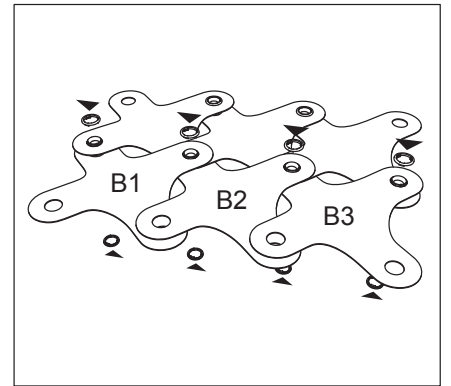
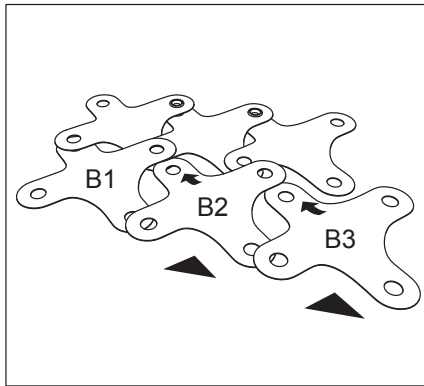
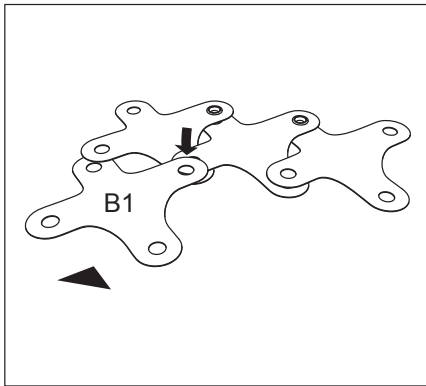

5- For the last row, connect the bottom of the last tiles together

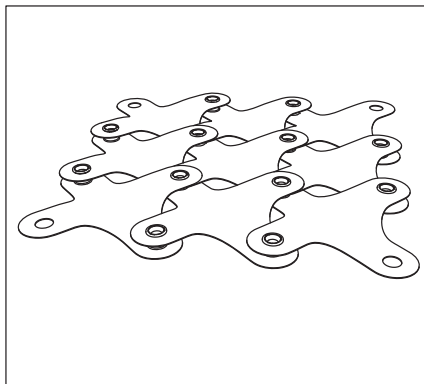
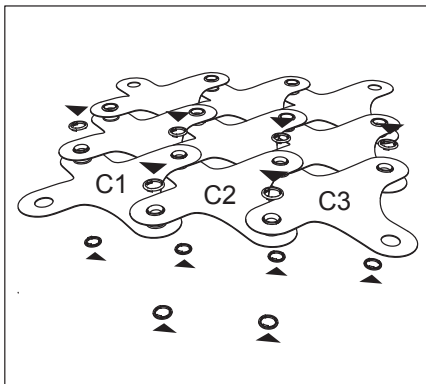

Installation

point support - wall or ceiling mounted

Use our Point Support system for close rigid connections to the wall or ceiling. Please see the Point Support parts catalog for options of barrel lengths. Use 1" diameter barrels with Ditto.

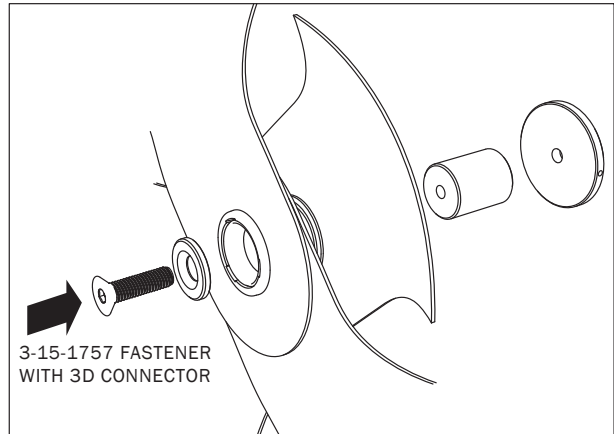
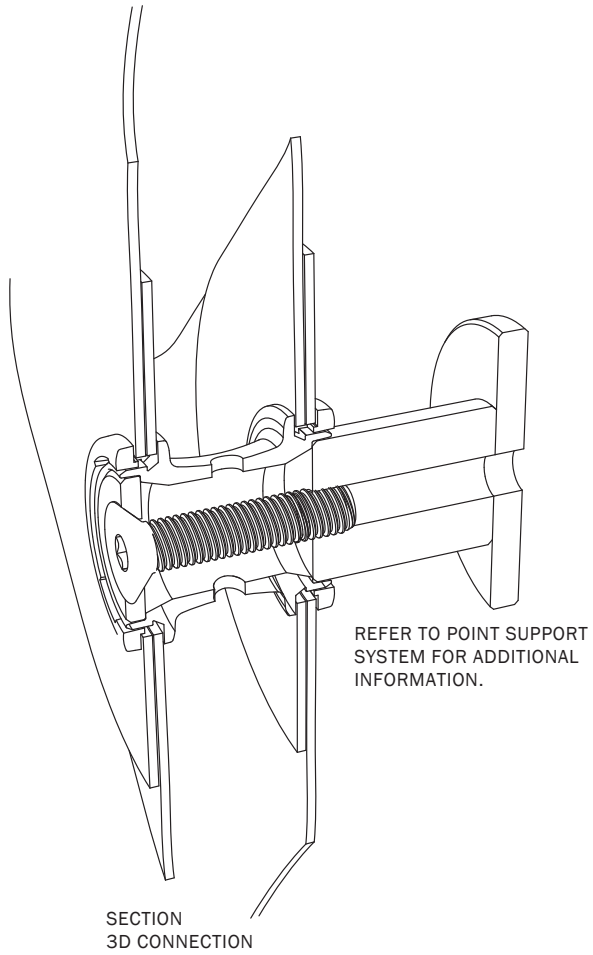

EXPLODED VIEW 3D CONNECTION

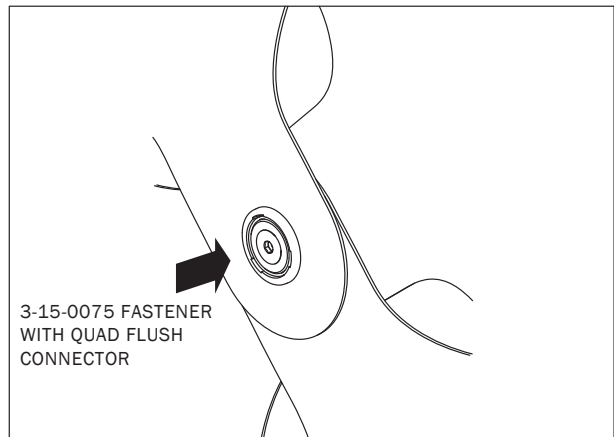

QUAD FLUSH CONNECTION

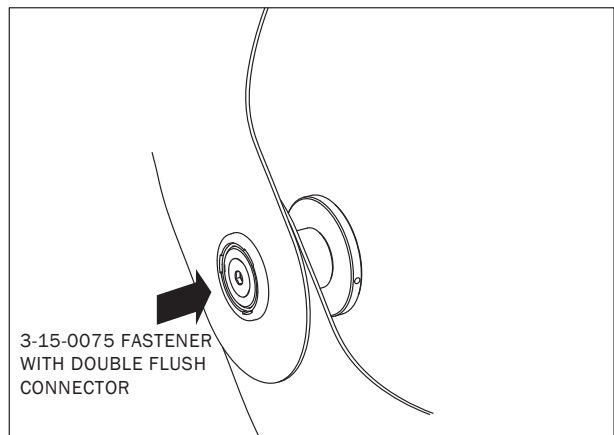

DOUBLE FLUSH CONNECTION

Installation

SUSPEND - PARTITION APPLICATION

Use our 3mm cable with couplers and tensioners for an easy floor-to-ceiling installation.

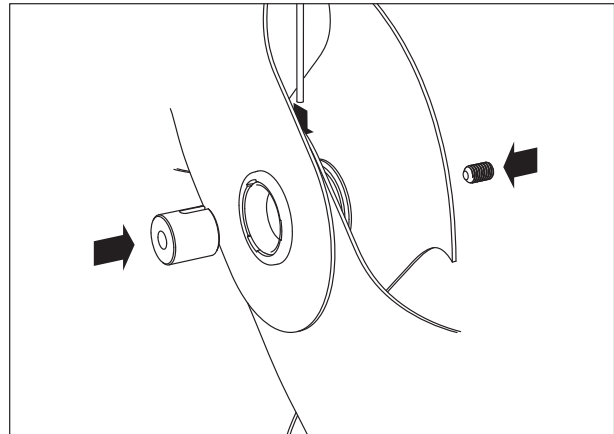
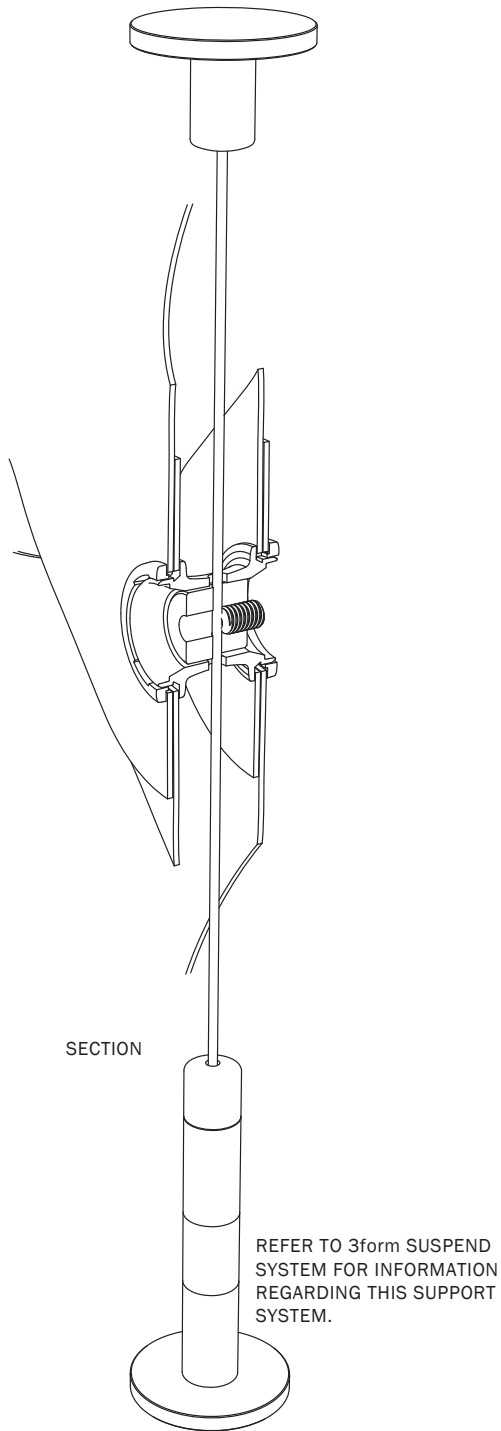

EXPLODED VIEW 3D CONNECTION

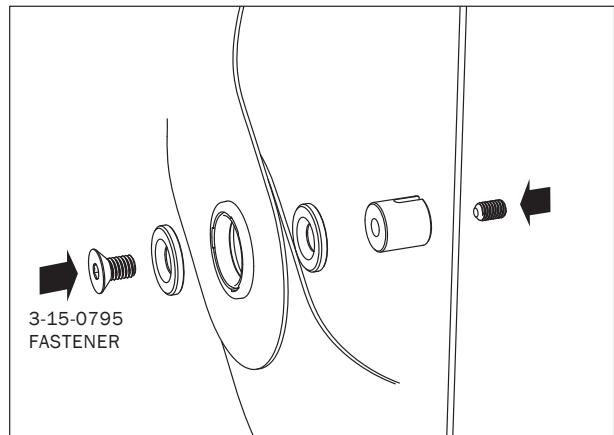

EXPLODED VIEW DOUBLE FLUSH CONNECTION

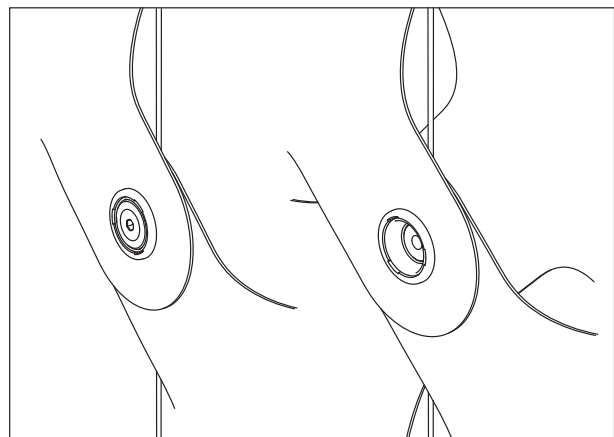

ASSEMBLED VIEW

Installation

CONNECTOR TILE - PARTITION APPLICATION

Attach the Ditto system directly to any surfaces using the Connector Tile and Ceiling Mount Plate. Fastening to ceiling substrate to be specified separately according to site conditions.

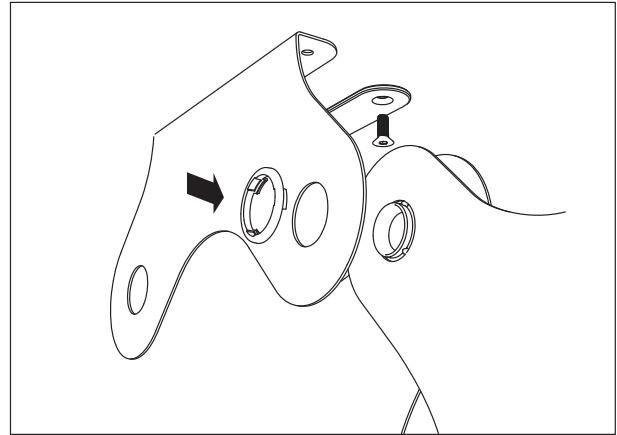
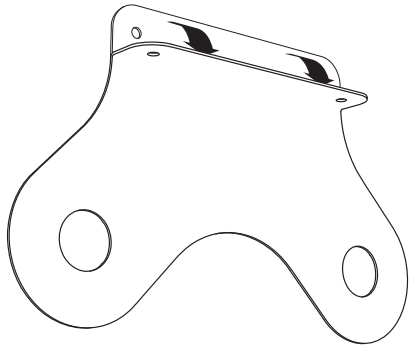

EXPLODED VIEW

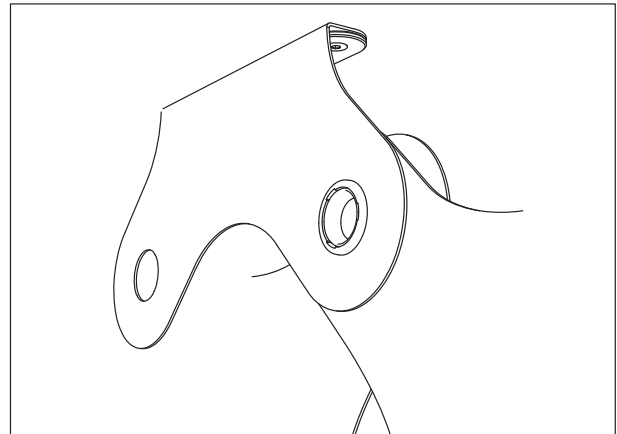
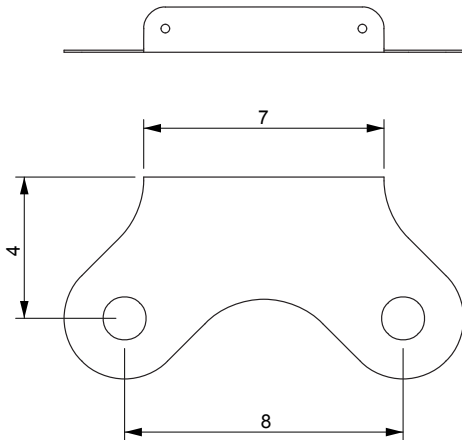

3D CONNECTION

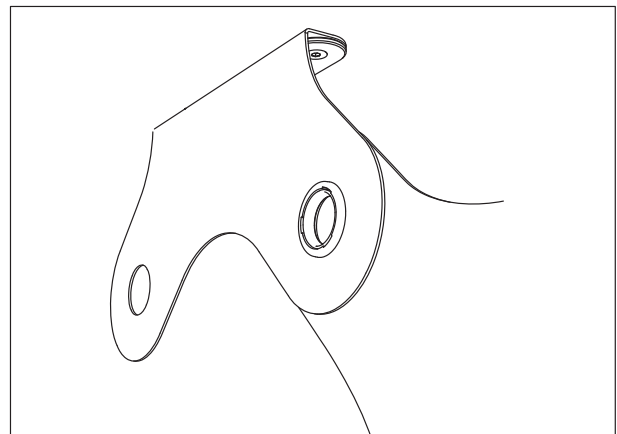

DOUBLE FLUSH CONNECTION

Installation

Threaded rod - Ceiling Application

Use our threaded rods with stainless steel sleeves from our Shapes collection to form rigid connections to the ceiling.

