

# Backlit Bottle Risers

## Contents

Materials	1
General Fabrication Details	2
Exterior Fabrication Details	3

## Materials

Chroma is ideal for seamed, lit bottle risers. This durable and versatile acrylic material can be backlit with white or RGB lighting, and the Renewable Matte finish provides the refinishability to keep these products looking new. The typical rise and run of each step is 4-7", and can have any number of steps for both indoor and outdoor use, making these fully customizable to the specific needs of your space!

Designed for standard bottle sizes, we recommend a weight distribution of no more than 10 lbs of weight per linear foot.



# Bottle Riser Fabrication

The images here show key details of a bottle riser design. The corner of each resin step will be seamed together to create a cohesive unit. The resin steps will rest passively over or be glazed onto the reflective panel box(es) made from marine grade plywood.

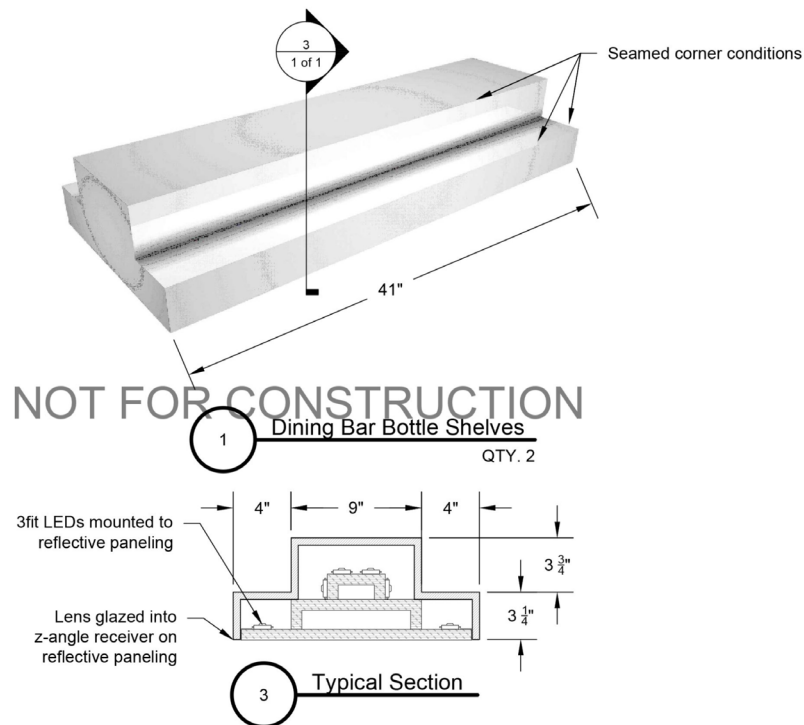
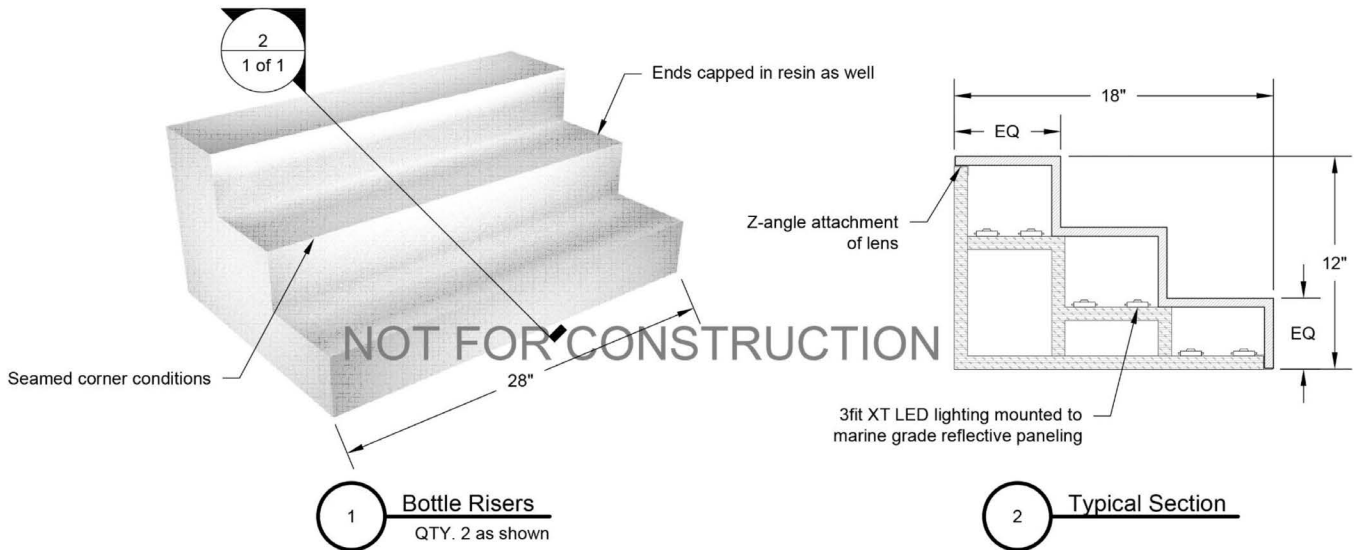

# Exterior Bottle Riser Fabrication

Exterior features will require expansion joints and slightly different joinery to accommodate exterior layups and allow room for greater expansion and contraction considering their exposure to larger temperature fluctuations. If the feature is curved we will use a combination of marine grade plywood and PETG to create the reflective box inside.

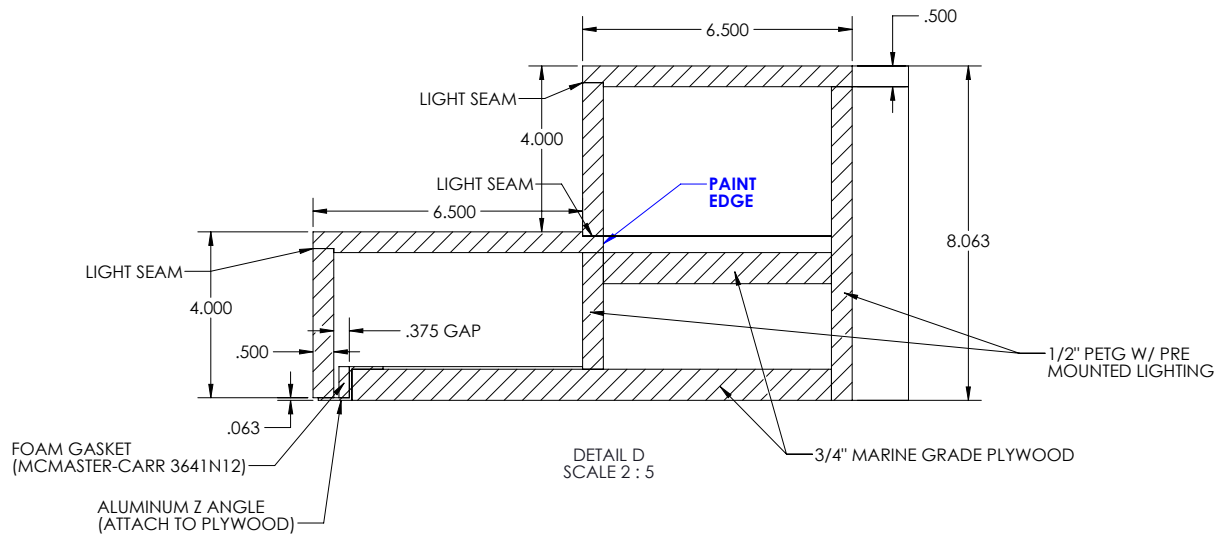
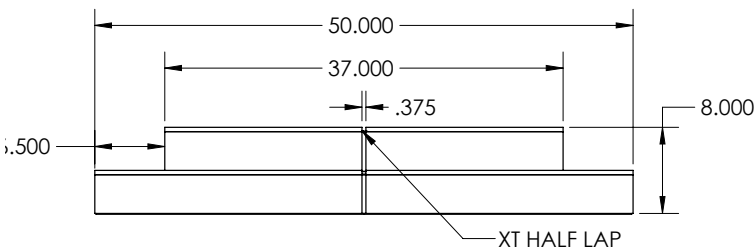
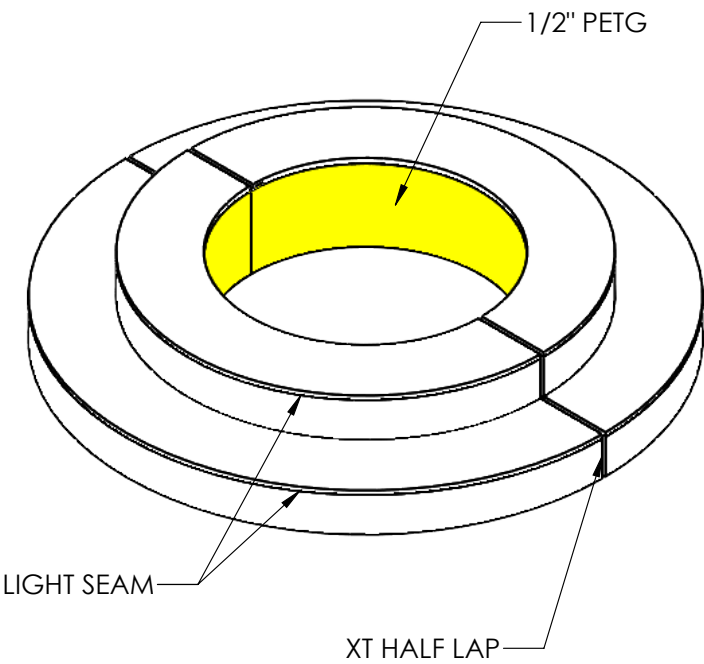



# Interior Bottle Riser

Before and after installation

For additional information about this solution, please contact your local Materials Consultant.

